

COLUMN E700 with Anti-Collision Sensor
PROFESSIONAL DISPLAY SUPPORT



COLUMN E700 is a motorized wall/floor support for large screens and touch screens up to 100" and 150Kg.

It comes standard with the anti-collision system to ensure maximum safety during its operation.

The 700 mm stroke allows you to position the screen from a minimum of 1159 mm to a maximum of 1859 mm (measured at the center of the screen). By combining COLUMN E700 with the Base (code 07182), the solution becomes self-supporting (without the need for wall fixing).

For Wall/Floor application it is mandatory to purchase the wall fixing system (code 07180 or 07181).

MODEL NAME

COLUMN E700 (cod 07179)

MAIN FEATURES

Min VESA: 200x200
Max VESA: 800x600

Screen dimension: 46" – 100"
Max screen weight: 150 Kg

Stroke 700mm

Colour: Black

Wired remote control

ACCESSORIES

Shelf (cod 07064)
Wall Fix for Concrete (cod 07180)
Dry Wall Fix for plasterboard (cod 07181)
Base (cod 07182)

WARRANTY

5 years

COUNTRY OF ORIGIN

Made in Italy

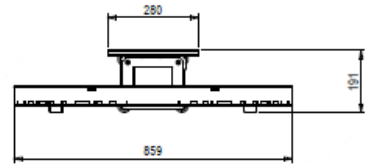
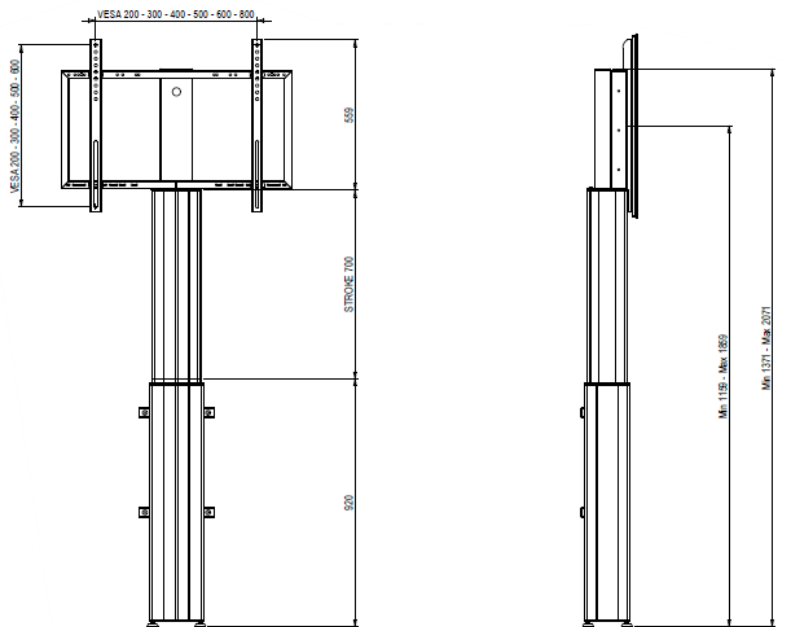

Six axis ANTI-COLLISION SENSOR

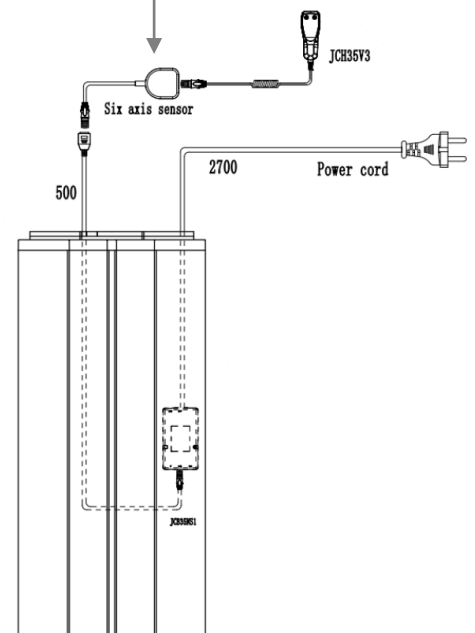

OPTIONAL

WALL FIX FOR CONCRETE WALL
Cod 07180

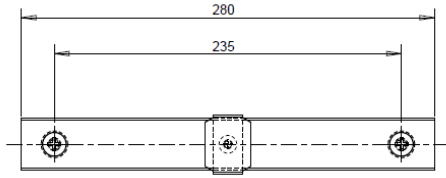

DRY WALL FIX FOR
PLASTERBOARD WALL
Cod 07181

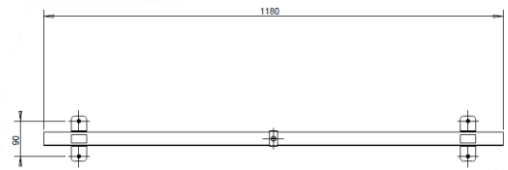

SHELF
Cod 07064

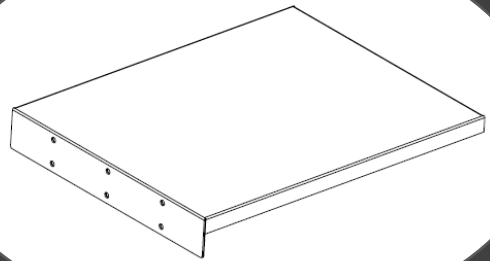

BASE
Cod 07182

